

PACK

Apparecchio per illuminazione di esterni e/o di interni costituito da:

- Corpo in alluminio pressofuso verniciato
- Copertura in alluminio pressofuso verniciato
- Diffusore in vetro
- Parabola riflettente in alluminio
- Guarnizioni in silicone
- Viti di chiusura in acciaio inox
- Verniciatura in polveri poliestere ad elevata resistenza ai raggi ultravioletti e alla corrosione

Outdoor and/or indoor luminaire constructed of:

- Painted die-cast aluminium body
- Die-cast painted aluminium cover
- Glass diffuser
- Aluminium reflector
- Silicon gaskets
- Stainless steel screws
- Painting using high resistance to UV and corrosion polyester powders



Colori - Colours

X=9  Antracite
Anthracite

X=4  Silver

Diffusore - Diffuser

Codice-Code 00 1300

Classe energetica : vedi pag. 356
Energy class : see page 356

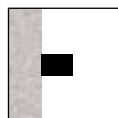

Installazione a parete
Wall mounting

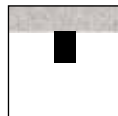

Installazione a soffitto
Ceiling mounting

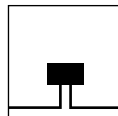

Doppia entrata cavi di alimentazione
Double power supply cables input

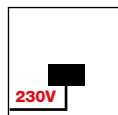

LED
Led a tensione di rete 220/240V 50/60Hz.
Connessione diretta alla rete di alimentazione
senza necessità di trasformatore.
LED's direct operation at 220/240V 50/60Hz.
No transformer is required.

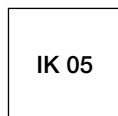

IK 05



Dimmerabile a taglio di fase.
Phase cut dimmable



1305

Copertura in alluminio pressofuso

Die-cast aluminium cover

1305.45X	LED	12,5W	1500 lm	4000 K
1305.46X	LED	13,6W	1500 lm	3000 K

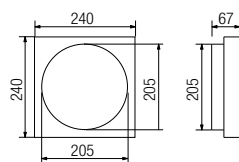

1308

Copertura in alluminio pressofuso

Die-cast aluminium cover

1308.45X	LED	12,5W	1500 lm	4000 K
1308.46X	LED	13,6W	1500 lm	3000 K

